

\* In the event that the drain pipe is required to be moved up above grade, it must be approved by the engineer of record and an impervious granular material must be placed below the drain pipe.

\* Refer to design details: Allan Block typical reinforced wall application for all other notes, details and specifications.

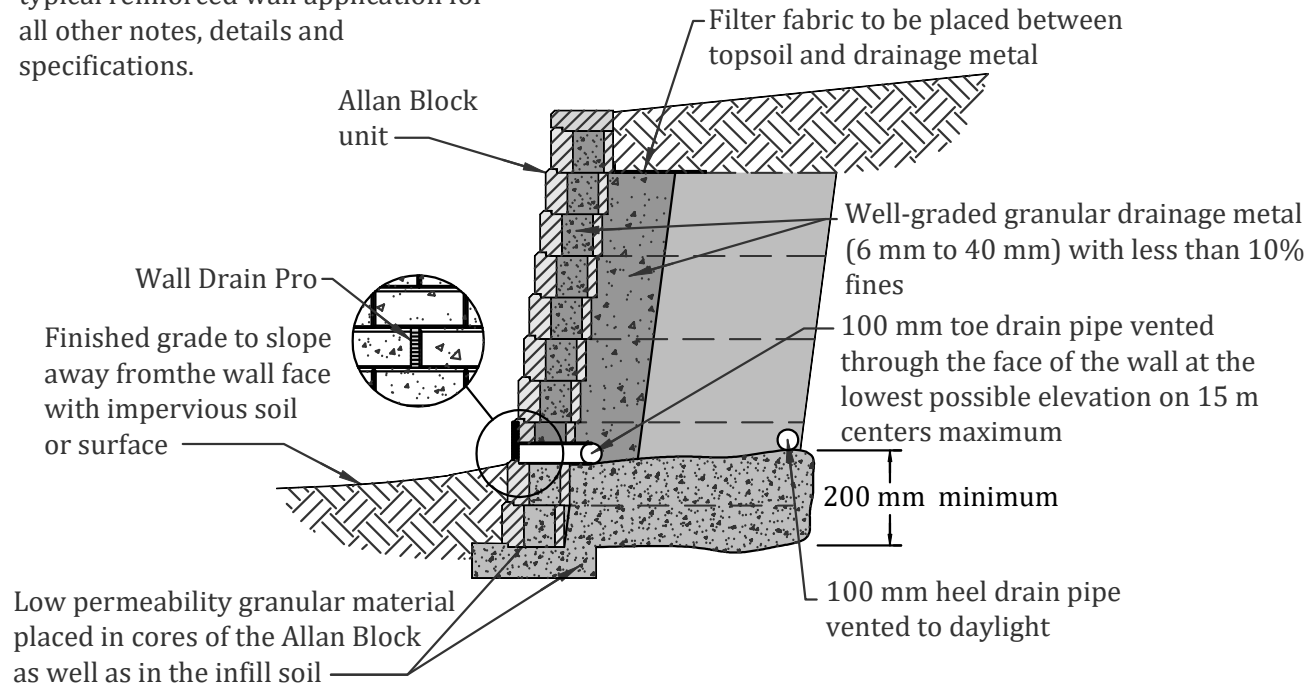

Designed By:

Title:

### AB-10 LEVEL GRADE DRAIN

Date:

Checked By:



ALLAN  
BLOCK  
allanblock.com

The purpose of this drawing is for preliminary design only. This should not be used for final design or construction without the certification of a professional engineer registered in the state in which the wall will be built. The accuracy and use of details contained in this document are the sole responsibility of the user. The user must verify each detail for accuracy as they pertain to their particular project.

Project No:

Scale:

Not to Scale

© 2021 Allan Block

Drawing No: